

**CONSTRUCTION NOTES**

- ① Place Mirafi 600X, or equivalent, over 1 foot of subgrade compacted to a minimum of 95 percent of the maximum dry density. Install geotextile in accordance with manufacturer's recommendations. Place full loose thickness of aggregate base over geotextile. Compact base to a minimum of 95% of the maximum dry density.
- ② Apply tack coat to all vertical and horizontal AC and concrete surfaces just prior to AC laydown.
- ③ Seal edges of repair area abutting existing pavement.
- ④ Restore all pavement markings and paint curbs in pavement reconstruction areas with traffic-rated paint.

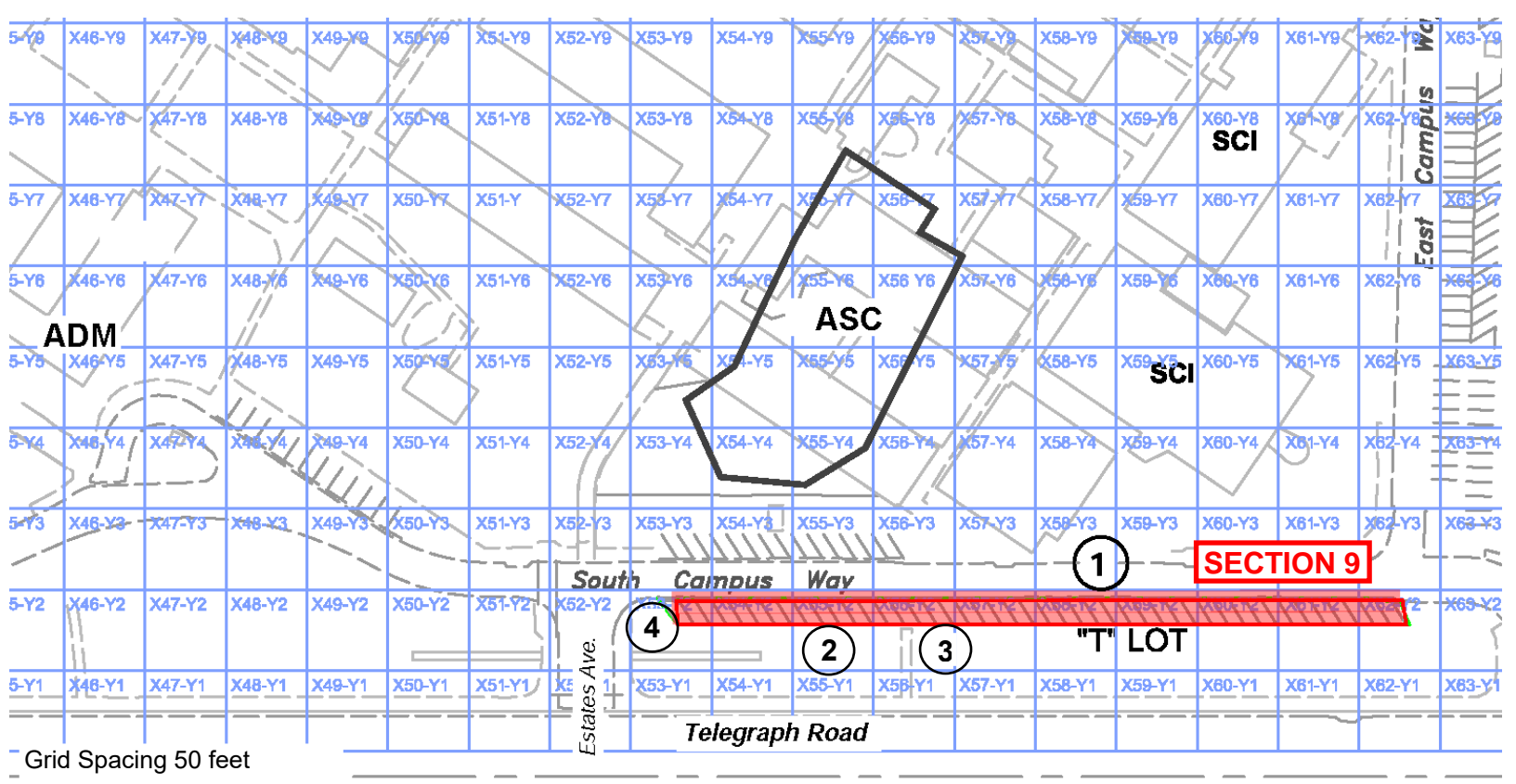

**GENERAL NOTES**

- A. Contractor to verify pavement areas and locations of existing utilities.
- B. Contractor to memorialize pavement markings and prepare existing elevation survey prior to pavement demolition and prepare plan showing proposed grades and surface drainage.
- C. Cuts in existing asphalt concrete shall provide a minimum 18-inch wide horizontal key at top of base course.
- D. Match finished grades to adjacent existing improvements.
- E. Install redwood header along unsupported pavement edges.
- F. Effect positive drainage on all new pavement surfaces. Drainage on new pavement surfaces shall be achieved by sheet flow and shall not be concentrated.

**2019 Ventura College Pavement Repair and Replacement**

Pavement	Maintenance	AC/Base Thickness	Notes
West Lot	Remove and replace	3"/6"	Compact upper 12" subgrade to ≥ 95% R.C., use Mirafi 600X on subgrade
Lot T	Remove and replace	2½"/4"	Compact upper 12" subgrade to ≥ 95% R.C., use Mirafi 600X on subgrade
East North Campus Way	Overlay	1½"	Grind and overlay, place Petromat per specifications

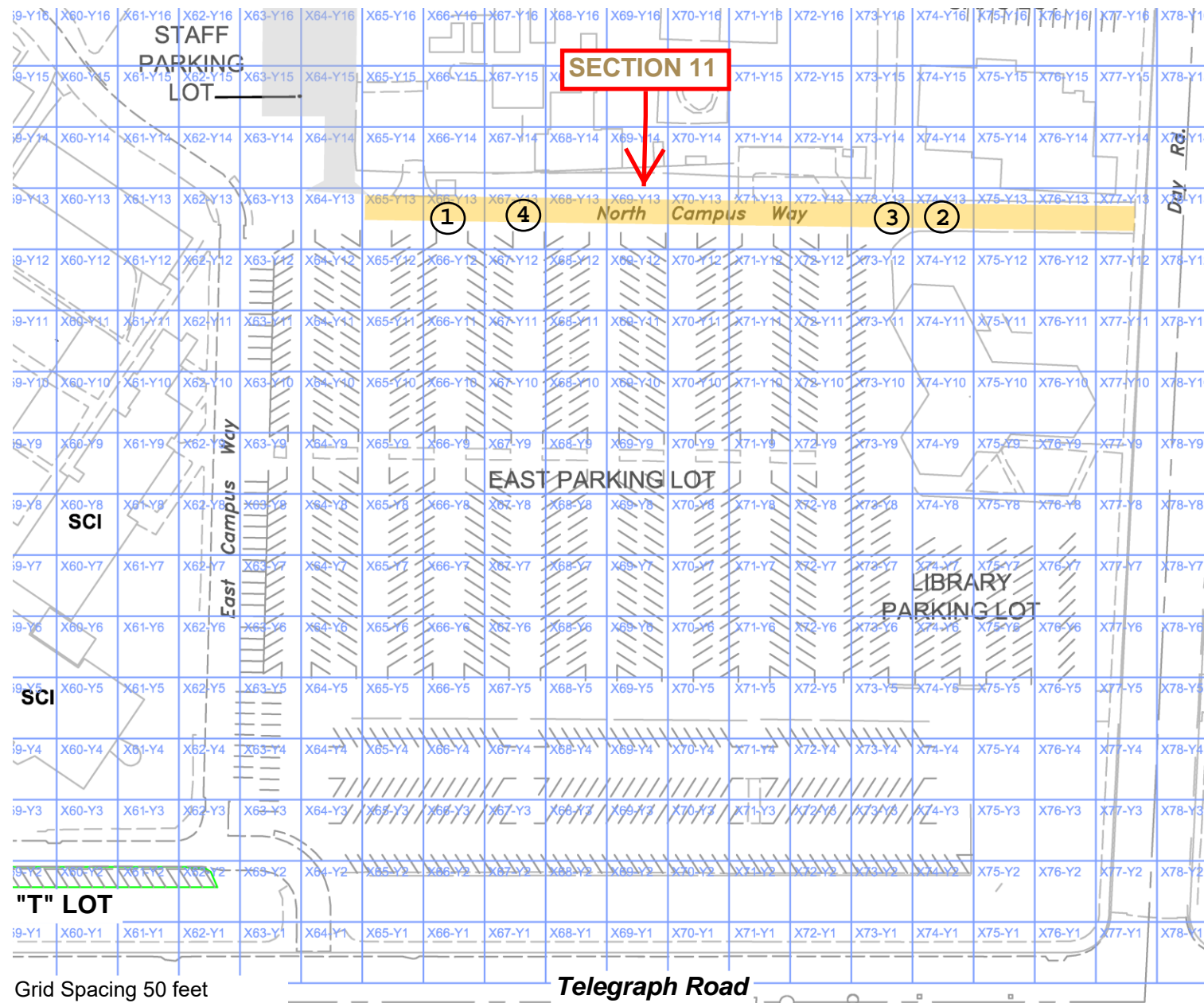

**CONSTRUCTION NOTES**

- ① Memorialize and restore all affected pavement markings with traffic-rated paint.
- ② Grind existing pavement to remove upper 1½ inches (minimum) of AC. Seal exposed cracks per specifications. Dig out areas exposing pavement distress.
- ③ Construct 1½-inch (final minimum compacted thickness) asphalt concrete overlay over existing pavement in accordance with specifications. Petromat or equivalent shall be used under overlay. Petromat shall be placed fuzzy-side-down and in strict accordance with manufacturer's recommendations. A tack coat consisting of uncut paving grade asphalt cement AR-4000 shall be applied over a clean pavement surface using an application rate of 0.25 gallon/sq. yd. Petromat shall be overlapped 2 to 3 inches and "shingled" in direction of rolling asphalt concrete overlay. Tack coat shall be applied to overlap joints. Maximum aggregate size of asphalt concrete for overlay shall be ½-inch.
- ④ Seal edges of repair area abutting existing pavement or concrete.

**GENERAL NOTES**

- A. Contractor to verify pavement areas and locations of existing utilities.
- B. Install redwood header along unsupported pavement edges. Replace header where necessary.
- C. Contractor to match finished grades to adjacent existing improvements.
- D. Perform all work in conformance with specifications.
- E. Contractor to effect positive drainage on all new pavement surfaces. Drainage on new pavement surfaces shall be achieved by sheet flow and shall not be concentrated except in drainage devices such as a concrete ribbon gutter.

**2019 Ventura College Pavement Repair and Replacement**

Pavement	Maintenance	AC/Base Thickness	Notes
West Lot	Remove and replace	3"/6"	Compact upper 12" subgrade to ≥ 95% R.C., use Mirafi 600X on subgrade
Lot T	Remove and replace	2½"/4"	Compact upper 12" subgrade to ≥ 95% R.C., use Mirafi 600X on subgrade
East North Campus Way	Overlay	1½"	Grind and overlay, place Petromat per specifications